

2150 (APPROX)

3000 (APPROX)

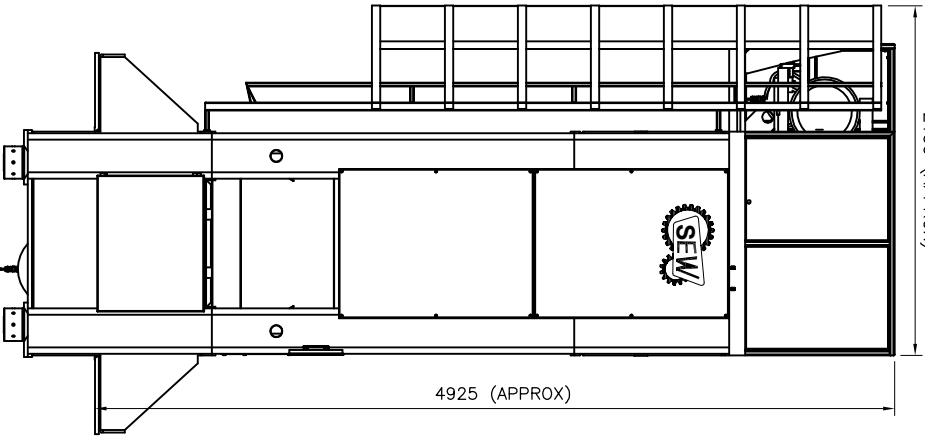

4925 (APPROX)

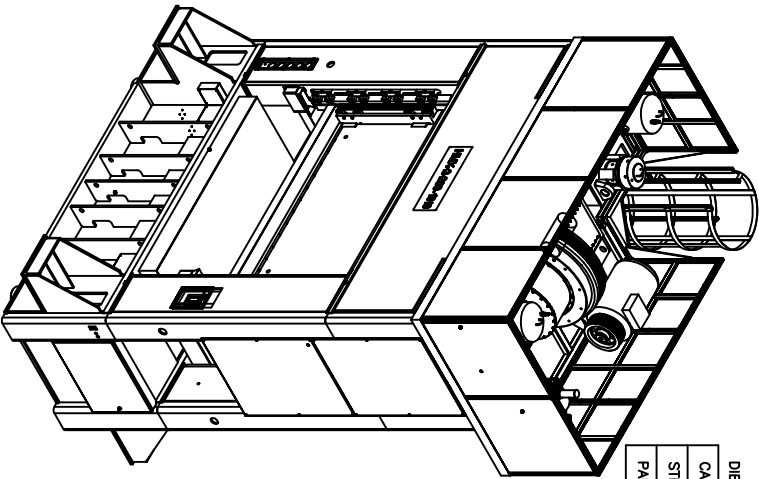
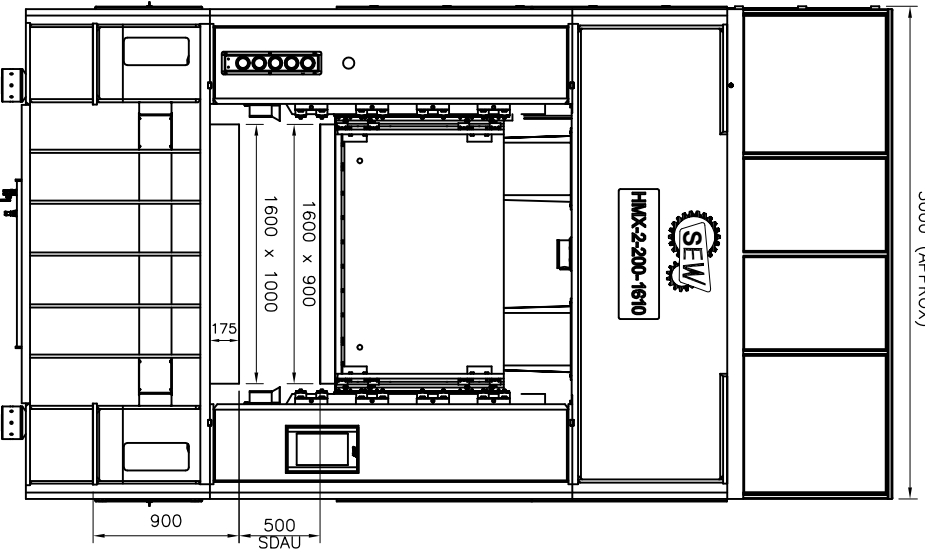

SPECIFICATION OF HMX-2-200

DESCRIPTION		UNIT
PRESS FORCE CAPACITY ● 6.5 mm FBOS	2000(200)	kN(t)
NUMBER OF SUSPENSION	2	
STROKE LENGTH	150	mm
STROKE PER MINUTE (VARIABLE)	50-100	spm
SHUT HEIGHT(SDAU)(MAX DIE HEIGHT)	500	mm
SLIDE ADJUSTMENT	125	mm
BOLSTER AREA (LR×FB)	1600×1000	mm
SLIDE AREA (LR×FB)	1600×900	mm
SIDE OPENING (FB×H)	800×500	mm
SLIDE GUIDING	8 POINT FLAT	
MAIN MOTOR	30	kW
FLOOR TO TOP OF BOLSTER (WITHOUT PAD)	900	mm
PRESS ACCORDING ACCURACY	JIS 6402-1985	
DRIVE	CENTRAL GEAR BOX	
LUBRICATION	CENTRALIZED RECIRCULATING OIL	

DIE CUSHION OPTIONAL

CAPACITY	280(28)	kN(t)
STROKE	150	mm
PAD AREA (LR×FB)	740×540×2	mm

SINGHAL
POWER PRESSES PVT.LTD



DRG. NO.

GA-HMX-2-200-150-08

DRAWN BY DP CHECKED BY VR APPROVED BY VR DATE 13/01/2020

SHEET 1 OF 1

NOTE:-DIMENSIONS AND SKETCHES ARE FOR REFERENCE ONLY