

SEW SPECIFICATION OF SCL-2-400-M (CRANKLESS DRIVE)		
DESCRIPTION	UNIT	
CAPACITY	T	400
RATING POINT	mm	13
NUMBER OF SUSPENSION	—	2
STROKE LENGTH	mm	400
CONTINUOUS SPEED (VARIABLE)	spm	12-25
MAX DIE HEIGHT (SDAU)	mm	850
SLIDE ADJUSTMENT (MOTORIZED)	mm	200
BOLSTER AREA (LRXFB)	mm	2500x1300
SLIDE AREA (LRXFB)	mm	2500x1300
SLIDE GUIDING	—	8
MAIN MOTOR	kW	45
FLOOR TO TOP OF BOLSTER	mm	600
PRESS ACCORDING ACCURACY	—	JIS 6402-1985 GRADE-1
DRIVE	—	ECCENTRIC GEAR
LUBRICATION	—	CENTRALIZED RECIRCULATING OIL
BOLSTER THICKNESS	mm	215

DIE CUSHION (OPTIONAL)		
DESCRIPTION	UNIT	
CAPACITY	tone	60
STROKE	mm	160
PAD AREA	mm	2050X1150



DRAWN BY	ABHI
CHECKED BY	VR
APPROVED BY	VR
DATE	26/06/2019

REV. NO.	ALTERATION	DATE	DRAWN BY

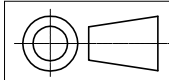

TITLE	G.A.DRAWING	DRG. NO.	SCL-2-400-M-08	REV.	00
-------	-------------	----------	----------------	------	----