

Blanking Operation - As per SEW recommendation, the maximum blanking load on the press should not exceed 60% of the press rated capacity when the working load is uniformly distribute in the bolster covering minimum 65% of central area

SPECIFICATION OF SNX-200 TONNE [GEARED]

| | |
|-------------------------------|------------------------|
| PRESS CAPACITY IN TONNE | 200 Tonne |
| STROKE LENGTH [FIX] | 220 mm |
| TONNAGE RATING POINT [B.D.C.] | 6 mm |
| SLIDE ADJUSTMENT | 120 mm[MOTORISED] |
| SLIDE AREA [LRxFB] | 860x650 mm |
| DIE HEIGHT [SDAU] | 450 mm |
| BOLSTER AREA [LRxFB] | 1400x840 mm |
| BOLSTER THICKNESS | 175 mm |
| THROAT DEPTH | 435 mm |
| CLEAR DIST. BETWEEN UPRIGHTS | 920 mm |
| MAIN MOTOR [HP x RPM] | 20x4P |
| MACHINE SPM. | 35 |
| FLOOR TO TOP OF BOLSTER | 1000 mm |
| OVER LOAD SAFETY | HYD. OVER LOAD |
| LUBRICATION | GREASE LUB. |
| CAM LIMIT SWITCH | ENCODER BASE E-CAMS |

VARIABLE

| | |
|-----------------------|-------|
| MACHINE SPM. | 25~45 |
| MAIN MOTOR [HP x RPM] | 25X4P |

DIE CUSHION (OPTIONAL)

| | |
|-------------------------|------------|
| PNEUMATIC DIE CUSHION | 14 Tonne. |
| DIE CUSHION STK. LENGTH | 110 |
| DIE CUSHION PAD AREA | 640x440 mm |

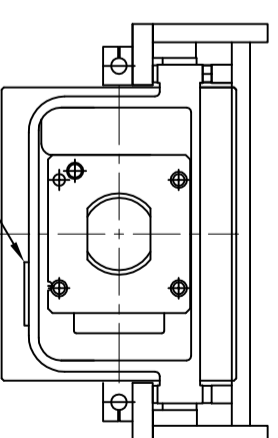

SIX POINT GIBBING
[DIE HEIGHT INDIMPERTEED]

| | | | | | | | | | | | | | |
|------|-------------|------|------|------|------|-------|--------|-------------|---------|------|----|----------------|-------------|
| REV. | DESCRIPTION | SIGN | DATE | NAME | DATE | SCALE | N.T.S. | NAME OF M/C | SNX-200 | QTY. | 01 | SURFACE FINISH | WEIGHT(KGS) |
| | | | | | | | | | | | | 0.8 | 1.6 |
| | | | | | | | | | | | | 3.2 | *** |
| | | | | | | | | | | | | | |
| | | | | | | | | | | | | | |
| | | | | | | | | | | | | | |
| | | | | | | | | | | | | | |
| | | | | | | | | | | | | | |
| | | | | | | | | | | | | | |
| | | | | | | | | | | | | | |
| | | | | | | | | | | | | | |



SINGHAL
POWER PRESSES PVT.LTD

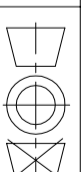

DRG. NO. SNX-200-SG-FS-008
G.A. DRAWING