

**SPECIFICATION OF SNXR-110 TONNE [GEARED]**

- PRESS CAPACITY IN TONNE ----- 110 Tonne
- STROKE LENGTH [FIX.] ----- 180 mm
- TONNAGE RATING POINT [B.D.C.] --- 5 mm
- SLIDE ADJUSTMENT ----- 90 mm[MOTORISED]
- SLIDE AREA [LRxRB] ----- 650x520 mm
- DIE HEIGHT [SDAU] ----- 360 mm
- BOLSTER AREA [LRxRB] ----- 1000x680 mm
- BOLSTER THICKNESS ----- 140 mm
- MAIN MOTOR ----- 10HPx4P
- MACHINE SPM. ----- 50
- FLOOR TO TOP OF BOLSTER ----- 900 mm
- OVER LOAD SEFTY ----- HYD. OVER LOAD
- LUBRICATION ----- MOTORISED GREASE LUB.
- CAM LIMIT 8 POINT IMPORTED

**DIE CUSHION (OPTION)**

- PNEUMATIC DIE CUSHION ----- 8 Tonne.
- DIE CUSHION STK. LENGTH ----- 90 mm
- DIE CUSHION PAD AREA ----- 480X300 mm

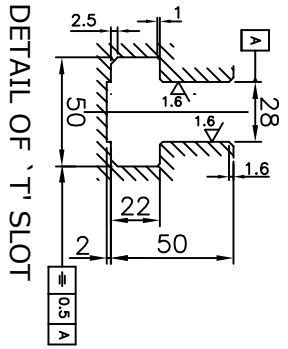

REV.	DESCRIPTION	SIGN	DATE	PROJECTION	A3	IT.NO	NAME OF M/C	SNXR-110	QTY.	REMARKS
							SCALE			WEIGHT(KGS)
							DATE	31/05/2015		NAME :
							DRAWN	PARESH		
							CHKD.			
							APPD.			
<b>G.A.DRAWING</b>										
DRG.NO. SNXR-110-08										

